

Packaging Options

nanoplus packaging options

nanoplus provides a wide variety of different packaging options from standard TO 5.6 mm and TO 9 mm headers to TO 5 headers and Butterfly packages with integrated TEC and thermistor and c-mounts. Customer-specific packaging is also available upon request.

nanoplus also offers accessories such as laser sockets and heat sinks.

TO 5.6 mm



Front View

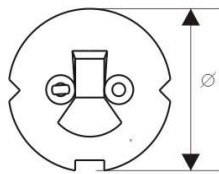

Back View

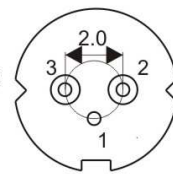

Side View

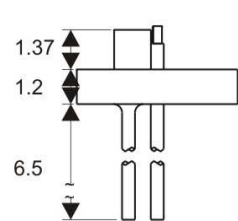

Pin Assignment:

1: Laser cathode /case

2: Laser anode

TO 5 with TEC and NTC



Front View

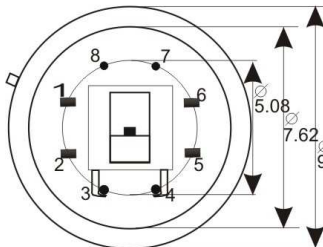

Side View

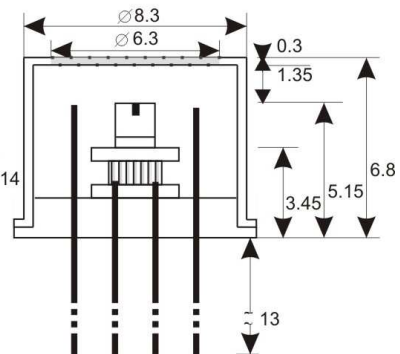

Pin Assignment:

1: Laser anode

2: Laser cathode

3: TEC cathode

4: TEC anode

5: thermistor

6: thermistor

TO 9 mm

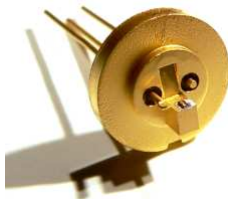

Front View

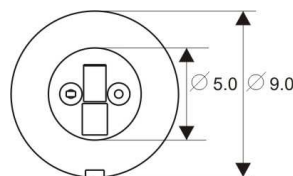

Back View

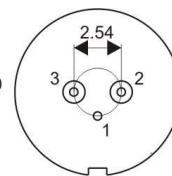

Side View

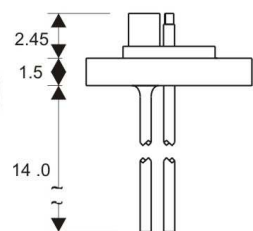

Pin Assignment:

1: Laser cathode /case

2: Laser anode

device protected by
 US patent 6.671.306
 US patent 6.846.689
 EU patent EP0984535

nanoplus
 Nanosystems and Technologies GmbH
 Oberer Kirschberg 4
 D-97218 Gerbrunn

phone: +49 (0) 931 90827-0
 fax: +49 (0) 931 90827-19
 email: sales@nanoplus.com
 internet: www.nanoplus.com

© copyright nanoplus GmbH 2010, all rights reserved.
 nanoplus GmbH reserves the right to modify these specifications
 at any time without notice and is not liable for errors.



14-pin Butterfly Package

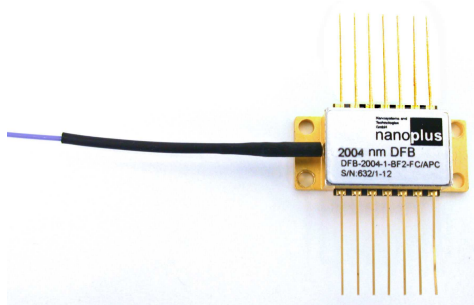

Pin Assignment:
 1: TEC anode 2: thermistor 5: thermistor
 9: Laser cathode 10: Laser anode
 14: TEC cathode

NTC and TEC:
 R0: 10kOhm
 V (max.): 2.80 V
 I (max.) : 3.35 A

Fiber and Connector:
 Single Mode, 1 m long, FC/APC or E2000/APC

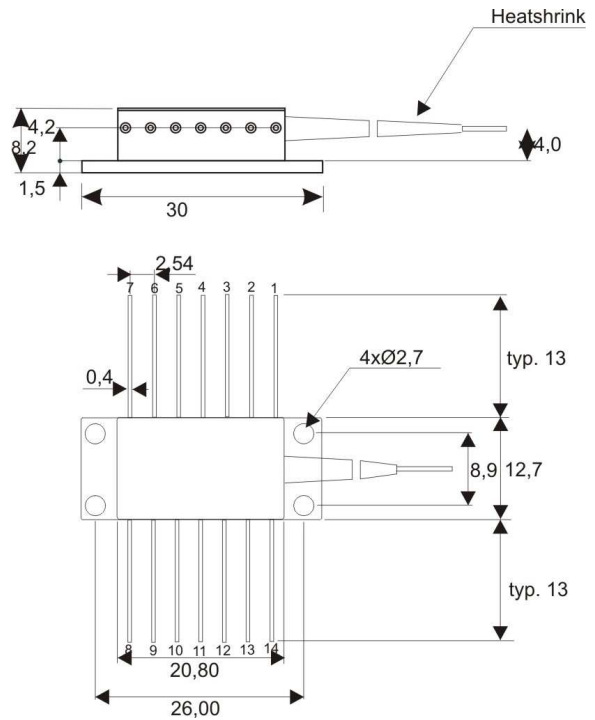

c-mount

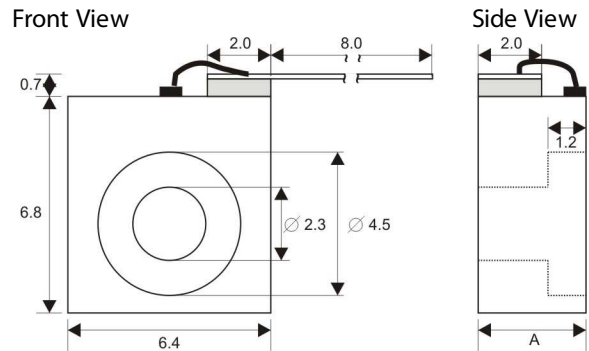
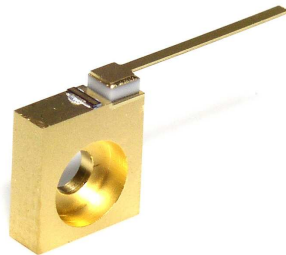

Type	A
c-mount-21	2.1
c-mount-28	2.75
c-mount-41	4.1

Accessories



Socket for TO 5.6 mm and TO 9 mm

Socket for TO 5

Heatsink for TO 8

BK7 caps, Sapphire caps, ZnSe caps, lens caps and black coated caps

All dimensions are in mm.

We will be happy to answer further questions. Please contact us at sales@nanoplus.com

